

135-105-2

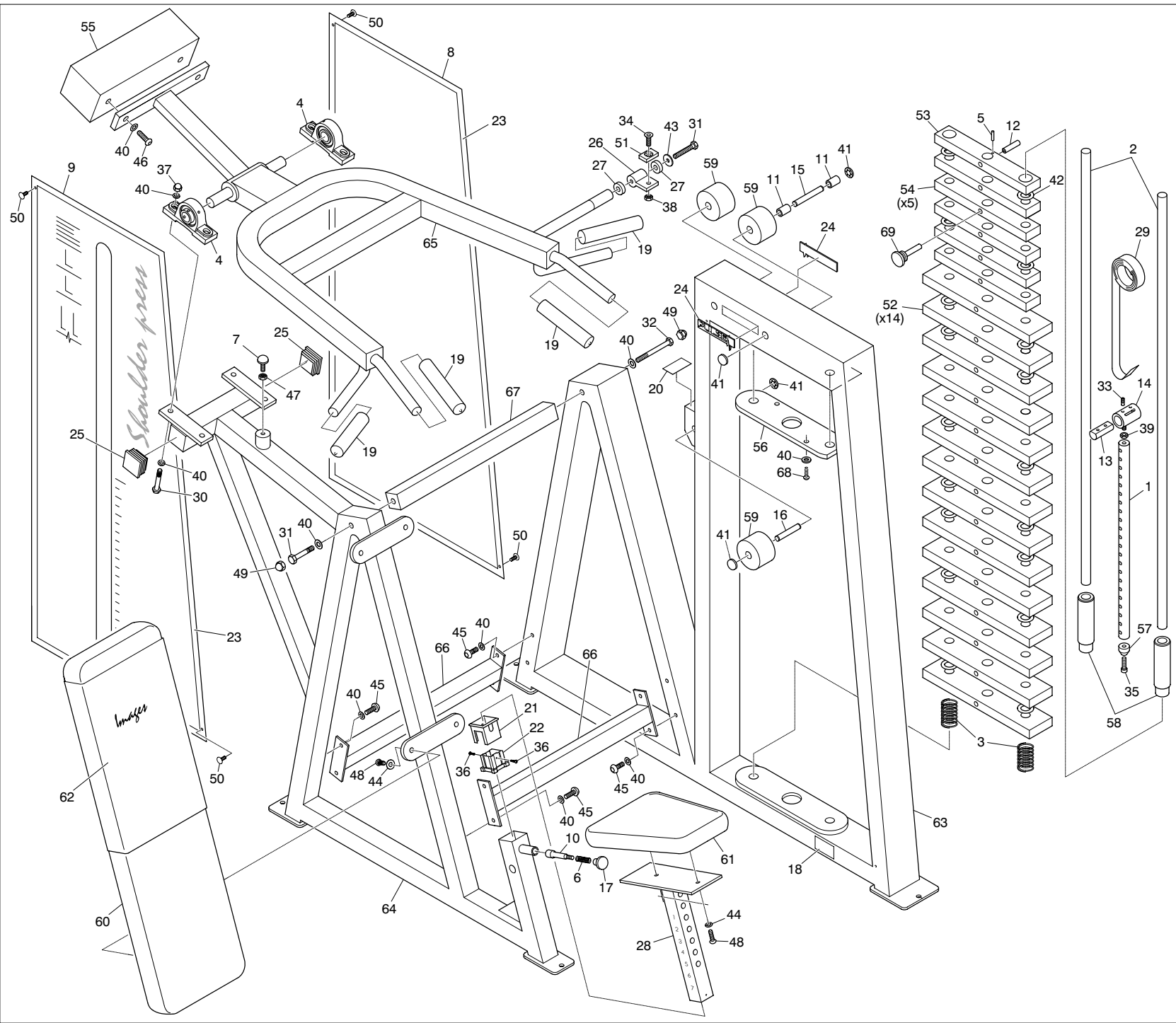

No.	Part No.	Description
1	10-102	Wt Stack Pin x 562 (CHROMED)
2	20-229	Guide Bars x 1302
3	26/002	55mm Compression Spring
4	26/022	UCP205/25 25id Cast Pillow Blk
5	26/042	Seloc Pin M3 x 25
6	26/067	Plunger Comp Spring S/S
7	26/263	Conical Bump Stop - 512251-50
8	29/047A	PX147 Rear Panel 585 x 1345
9	29/063A	PX163 Front Panel
10	30-276	Plunger
11	30-326	Pulley Spacers for 100mm RHS
12	30-407	12 Dia x 75 long Tube Spacer
13	30-586	Belt Clamp Bar 22d x 55mm long
14	30-677	Belt Clamp (CHROMED)
15	30-985	Pulley Spindle x 110
16	30-987	Pulley Spindle x 70
17	30/022	Blk Plastic Knob with M10 thrd.
18	30/037	Ser No Labels .002in unlined
19	30/048	22.23mm IDx154mm Length Grip
20	30/062	Check Point Labels
21	30/065	Black Outer Inserts 40 x 40 x 2
22	30/066	White Inner Inserts 40 x 40 x 2
23	30/070	Magnetic Strip ABR20
24	30/080	120mm Pulse Nameplate (CHROMED)
25	30/222	Endcap 2in x 2in 10-14 Type
26	30-602	Swivel Boss Assembly (CHROMED)
27	26/083	Radial Ball Bearing
28	305-102	Seat Assembly (CHROMED)
29	33/025	Regulator Strap 25mm wide
30	35/009	M10 x 40 Hex Head HT Bolt
31	35/023	M10 x 70 Hex Head HT Bolt
32	35/027	M10 x 120 Hex Head HT Bolt
33	35/044	M8 x 12 Hex Sckt Grub Screw
34	35/045	M10 x 35 Hex Sckt Csk Hd Screw
35	35/054	M6 x 30 Sckt Head Cap Screw
36	35/064	No6 x 1/2" Self tapping Screw
37	35/068C	M10 Domenuts (CHROMED)
38	35/071	M10 Nyloc Nut 'T' Type
39	35/073	M10 Lock Nut Right Hand
40	35/074	M10 Washer Form 'B'
41	35/075	1/2in Starlock Domewasher
42	35/076	Plastic Washer 1.1/2in od
43	35/081	M10 Washer Special
44	35/089	M8 Flat Washer
45	35/092	M10 x 25 Hex Skt Button Hd Screw
46	35/097	M10 x 35 Hex Skt Button Hd Screw
47	35/102	M8 Locknut
48	35/108	M8 x 30 Hex Skt Button Hd Screw
49	35/113	M10 Black Protection Cap
50	35/200	Pine Tree Clips G Head
51	60-100	Clamp Plates (CHROMED)
52	60-106	75 x 25 x 352 Plastic 5kg Std Wt
53	60-135	50 x 25 x 300 Plastic 2.5kg Top Wt
54	60-136	50 x 25 x 300 Plastic 2.5kg Std Wt
55	60-148	Counter Balance Weight
56	60-264	Guide Bar Locating Plate
57	70-101	Nylon Mufflet
58	70-106	Top Weight Insert
59	70-301	Pulley for low Line Models
60	U305/0001	Back Rest Pad
61	U305/0002	Seat Pad
62	U305/0003	Back Rest Pad Wear Cover
63	305-E3	Main Frame
64	305-E4	Seat Frame
65	305-E5	Handle
66	305-E6	Tie Bar
67	305-E7	Tie Bar
68	35/097	M10 x 35 Button Head
69	Mag Pin	Multi Pin 30-835

305E Shoulder Press