

135-106-1

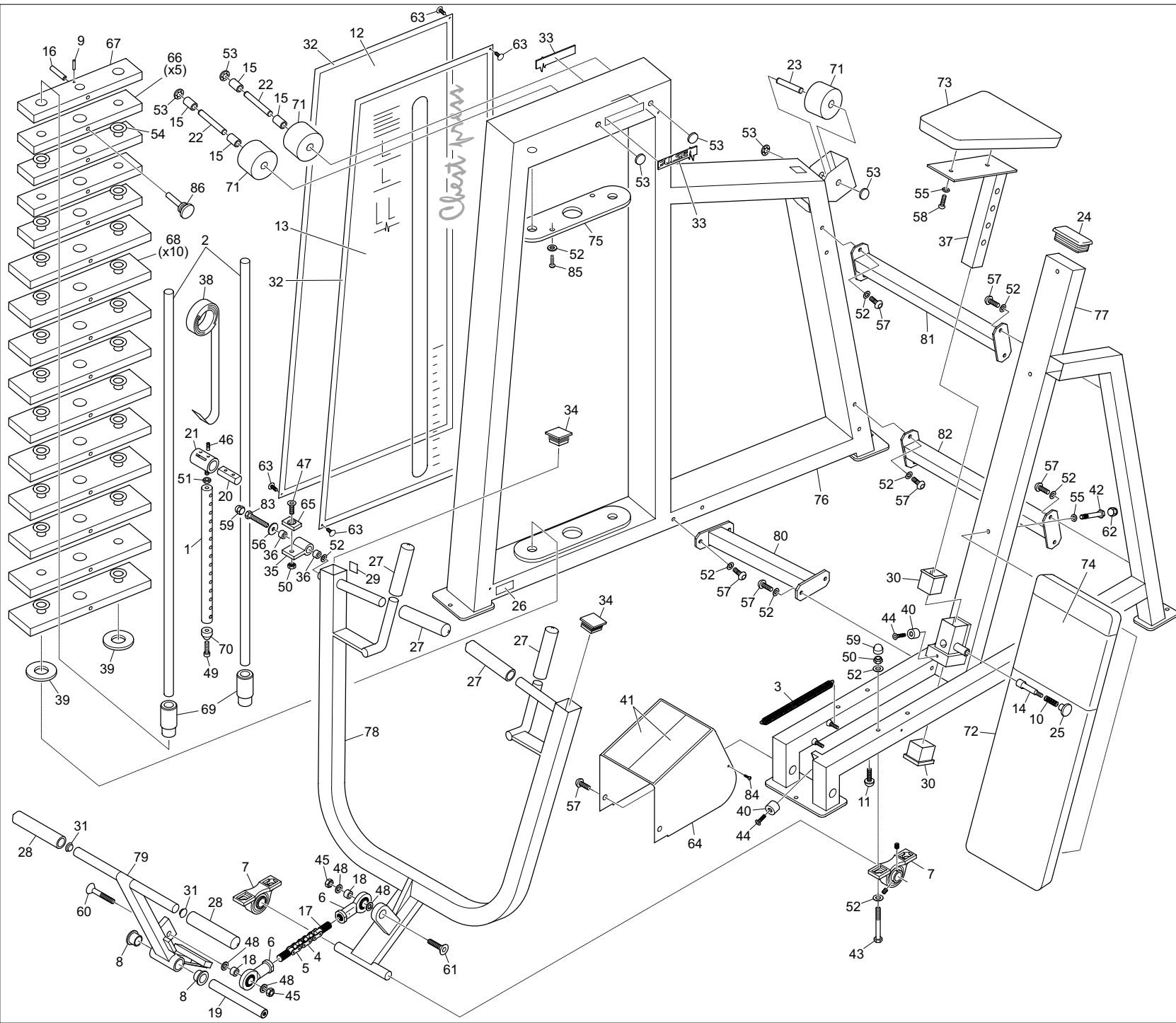

No.	Part No.	Description
1	10-103	100Kg Wt Stack Pin x 416mm
2	20-229	Guide Bars x 1302
3	26/003	Expansion Spring for 310
4	26/018	Metres PTB110066 Chain .75in
5	26/019	PTB110066/26 Split Link .75in
6	26/020	GIR20 PTFE Lined Bearing RH
7	26/022	UCP205/25 25id Cast Pillow Blk
8	26/031	FBM20/20 25id 32od x 20 Flanged
9	26/042	Seloc Pin M3 x 25
10	26/067	Plunger Comp Spring S/S
11	26/263	Conical Bump Stop - 512251-50
12	29/047A	PX147 Rear Panel 585 x 1345
13	29/064A	PX164 Front Panel (PRINTED)
14	30-276	Plunger
15	30-325	Pulley Spacers for 127mm RHS
16	30-407	12 Dia x 75 long Tube Spacer
17	30-451	Chain Connector M20 x 50mm
18	30-494	Rod End Bush
19	30-570	Shaft x 197mm
20	30-586	Belt Clamp Bar 22d x 55mm long
21	30-677	Belt Clamp (CHROMED)
22	30-986	Pulley Spindle x 137
23	30-987	Pulley Spindle x 70
24	30/002	100 x 50 x 2-4 Black Ribbed Insr.
25	30/022	Blk Plastic Knob with M10 thrd.
26	30/037	Ser No Labels .002in unlined
27	30/048	22.23mm ID x 154mm Length Grip
28	30/060	3 Inch Flocken Hand Grips
29	30/062	Check Point Labels Self Adh
30	30/065	Black Outer Inserts 40 x 40 x 2
31	30/067	Round Inserts O/D 25mm
32	30/070	Magnetic Strip ABR20
33	30/080	120mm Pulse Nameplate (CHROMED)
34	30/222	Endcap 2in x 2in 10-14 Type
35	305-101	Swivel Bearing Sub Assembly
36	26/083	Radial Ball Bearing 10mm ID
37	310-101	Seat Assembly (CHROMED)
38	33/025	Regulator Strap 25mm Wide
39	34/001	Weight Stack Buffers 70 OD x 21
40	34/013	Rubber Bump Stop 25d x 20
41	34/031	Safety Walk 4in Wide in Reels
42	35/018	M8 x 75 Hex Head HT Bolt
43	35/024	M10 x 80 Hex Head HT Bolt
44	35/034	M6 x 25 Hex Sckt Csk Hd Screw
45	35/037	M12 Nyloc Nuts "T" Type
46	35/044	M8 x 12 Hex Sckt Grub Screw
47	35/045	M10 x 35 Hex Sckt Csk Hd Screw
48	35/048	M12 Washers Form A
49	35/054	M6 x 30 Caphead
50	35/071	M10 Nyloc Nut "T" Type
51	35/073	M10 Lock Nut Right Hand
52	35/074	M10 Washer Form "B"
53	35/075	1/2in Starlock Domewasher
54	35/076	Plastic Washer 1.1/2in od X
55	35/080	M8 Washer
56	35/081C	M10 Washer Special
57	35/092	M10 x 25 Hex Skt Button Hd Screw
58	35/108	M8 x 30 Hex Skt Button Hd Screw
59	35/113	M10 Black Protection Cap
60	35/116	M12 x 70 Hex Skt C/NK Hd Screw
61	35/117	M12 x 50 Hex Skt C/NK Hd Screw
62	35/122	M8 Black Protection Cap
63	35/200	Pine Tree Clips G Head
64	6-226	Foot Guard
65	60-100	Clamp Plates (CHROMED)
66	60-106	75 x 25 x 352 Plastic 5kg Std Wt
67	60-107	75 x 25 x 352 Plastic 5kg Top Wt
68	60-294	7.5Kg Weight Coated
69	70-272	Top Weight Insert
70	70-101	Muffel
71	70-301	Pulley for low Line Models
72	U305/0001	Backrest
73	U305/0002	Seat
74	U305/0003	Wear Cover
75	60-264	Guide Bar Location Plate
76	310-E3	Side Frame
77	310-E4	Seat Frame
78	310-E5	Arm Assembly
79	310-E6	Pre Stretch Bar
80	310-E8	Tie Beam Front
81	310-E9	Tie Beam Centre
82	310-E10	Tie Beam Rear
83	30/022	M10 x 60 HT Bolt
84	35/067	No 6 Self Tapper
85	35/097	M10 x 35 Button Head
86	Mag Pin	Multi Pin 30-835

310E Chest Press