

135-117-1

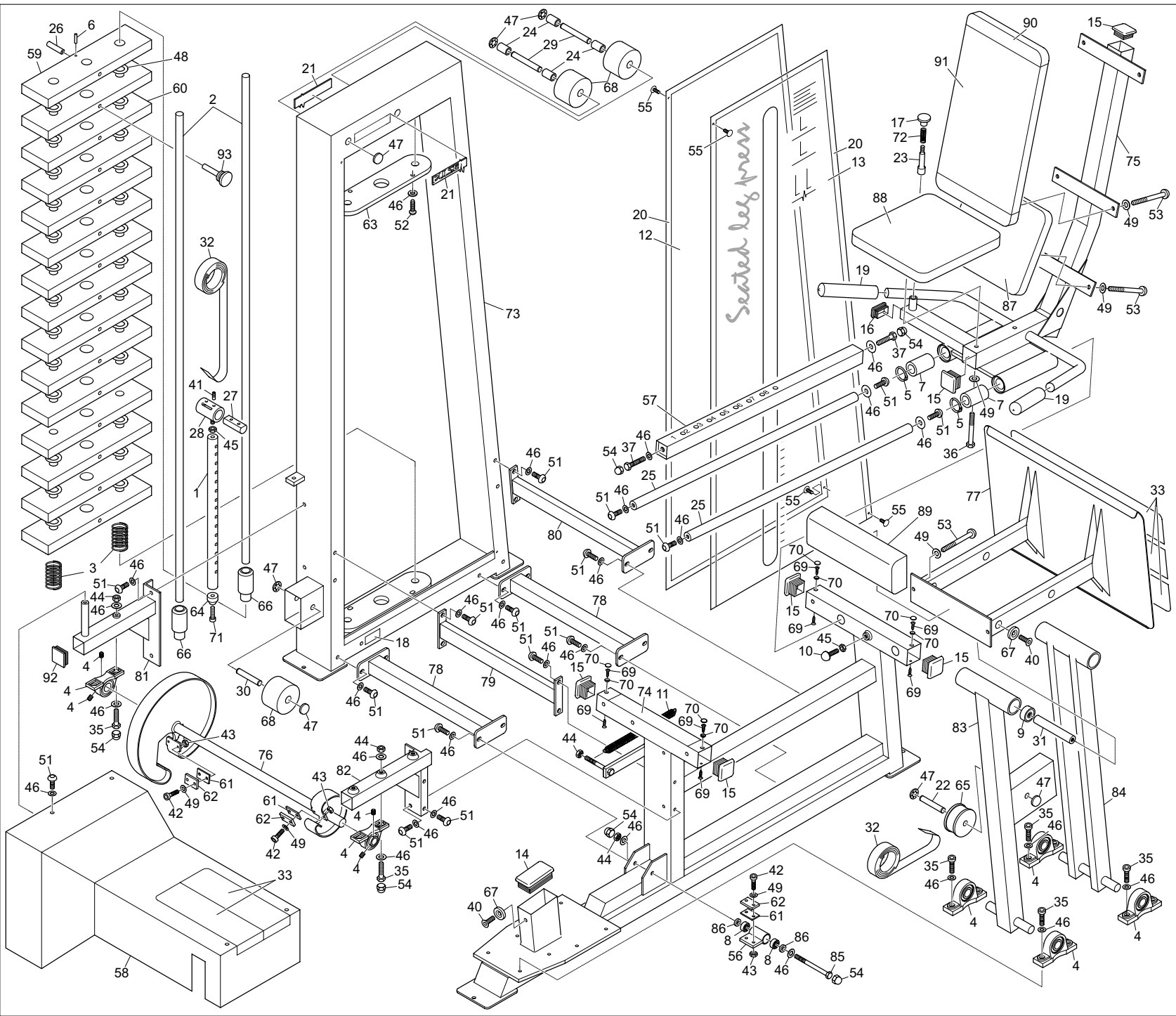

No.	Part No.	Description
1	10-104	Wt Stack Pin x 488 (CHROMED)
2	20-210	Guide Bar x 1595 (CHROMED)
3	26/002	55mm Compression Spring
4	26/022	UCP205/25 25id Cast Pillow Blk
5	26/038	1300/40 Circlip - 40 OD Collar
6	26/042	Seloc Pin M3 x 25
7	26/049	SSEM25 Plastic Linear Bearing
8	26/083	Radial Ball Bearing 10mm ID
9	26/085	Rotary Ball Bearing 6004.2ZZ
10	26/263	Conical Bump Stop - 512251-50
11	26/107	Tension Spring 17.17 OD x 400
12	29/060A	PX185 Perspex Rear Panel
13	29/076A	PX176 Front Panel
14	30/022	100 x 50 x 2-4 Black Ribbed Insert
15	30/005	50 x 50 x 3.2/5 Blk Ribbed Insert
16	30/006	50 x 30 x 2.6/3.2 Blk Ribbed Insert
17	30/022	Blk Plastic Knob with M10 Thrd
18	30/037	Serial No Labels .002in unlined
19	30/048	22.23mm ID x 154mm Length Grip
20	30/070	Magnetic Strip ABR20
21	30/080	120mm Pulse Nameplate
22	30-110	Pulley Spindle x 60mm
23	30-293	Plunger - Hip Conditioner
24	30-325	Pulley Spacers for 127mm RHS
25	30-334	Steel Shaft 25 Dia x 835
26	30-407	12 Dia x 75 Long Tube Spacer
27	30-586	Belt Clamp Bar 22D x 55mm Long
28	30-677	Belt Clamp
29	30-986	Pulley Spindle x 70
30	30-987	Pulley Spindle x 70
31	31-421	Shaft x 249 for 577
32	33/025	Regulator Strap 25mm wide
33	34/031	Safety Walk 4in wide in Reels
34	35/009	M10 x 40 Hex Head HT Bolt
35	35/017	M10 x 30 Hex Head HT Set Screw
36	35/018	M8 x 75 Hex Head HT Bolt
37	35/023	M10 x 70 Hex Head HT Bolt
38	35/024	M10 x 80 Hex Head HT Bolt
39	35/041	M10 x 10 Skt Head Grub Screw
40	35/042	M10 x 30 Hex Sckt Csk HD Screw
41	35/044	M8 x 12 Hex Sckt Grub Screw
42	35/055	M8 x 35 Hex Sckt Knurl Cap Screw
43	35/069	M8 Nyloc Nut 'T' Type
44	35/071	M10 Nyloc Nut 'T' Type
45	35/073	M10 Lock Nut Right Hand
46	35/074	M10 Washer Form 'B'
47	35/075	1/2in Starlock Domewasher
48	35/076	Plastic Washer 1.1/2in od
49	35/080	M8 Washer Form A Bright Zinc
50	35/081C	M10 Washer Special (CHROMED)
51	35/092	M10 x 25 Hex Skt Button Hd Screw
52	35/097	M10 x 35 Hex Skt Button Hd Screw
53	35/108	M8 x 30 Hex Skt Button Hd Screw
54	35/113	M10 Black Protection Cap
55	35/200	Pine Tree Clips G Head
56	577-101	Belt Clamp Welded Assy
57	577-102	Seat Adjuster (CHROMED)
58	6-154	Cam Guard for 577
59	60-117	100 x 30 x 390 Plastic 10Kg Top Wt
60	60-118	100 x 30 x 390 Plastic 10Kg Std Wt
61	60-238	Belt Clamp Packer Aluminium
62	60-239	Belt Clamp Plate
63	60-264	Guide Bar Locating Plate
64	70-101	Nylon Muffe 25mm Dia
65	70-104	Std Belt Pulley Drawing
66	70-106	Top Weight Insert
67	70-157	38 Dia x 10 Thick Washer
68	70-301	Pulley for Low Line models
69	35/240	8 x 3/4in C/Sunk HD Pozi Self
70	35/241	Plastop - Screw Caps
71	35/054	M6 x 30 Sckt HD Cap Screw
72	26/067	Plunger Comp Spring S/S
73	577-E3	Weight Frame Assembly
74	577-E4	Seat Frame Assembly
75	577-E5	Seat Frame Assembly
76	577-E6	Welded Cam Assembly
77	577-E7	Foot Plate Assembly
78	577-E8	Tie Bar Assembly
79	577-E9	Tie Bar Assembly
80	577-E10	Tie Bar Assembly
81	577-E11	Rear Bearing Bracket
82	577-E12	Front Bearing Bracket
83	577-E13	Arm Assembly
84	577-E14	Arm Assembly
85	35/029	M10 x 90 Hex HD HT Bolt
86	70-328	20 Dia Nylon Spacer
87	U577/0001	Covered Lower Backboard
88	U577/0002	Covered Seat
89	U577/0003	Covered Footplate Pad
90	U577/0004	Covered Upper Backboard
91	U577/0005	Upper Backboard Wear Cover
92	30/007	40 x 40 x 3 Blk Ribbed Endcaps
93	30/017	Multi Pin 30-835

577E Seated Leg Press