

135-118-2

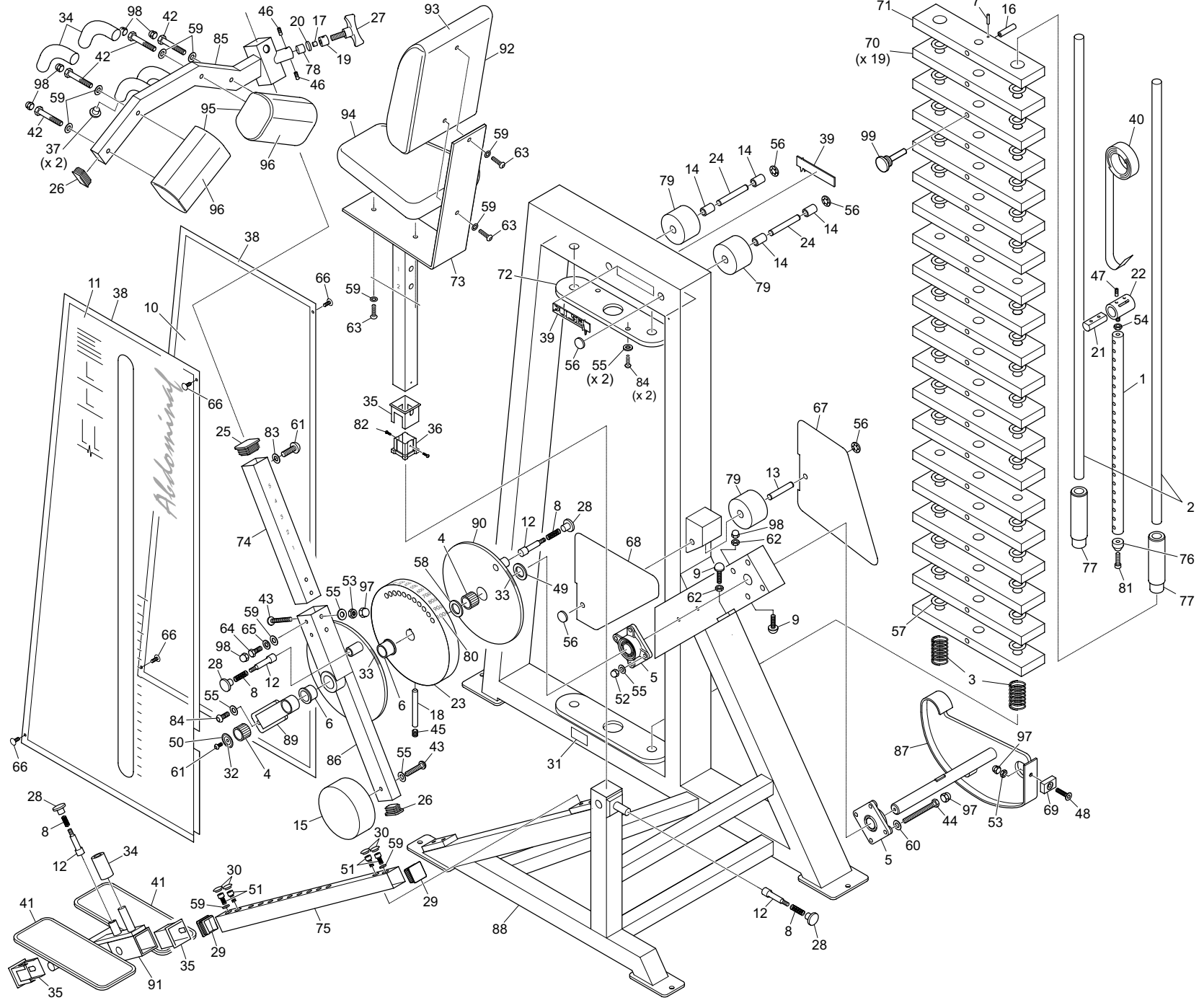

No.	Part No.	Description
1	10-102	Wt Stack Pin x 562 (CHROMED)
2	20-229	Guide Bars x 1302
3	26/002	C7275 Comp Spring 55mm long
4	26/013	NK1125/30 Needle Roller Bearing
5	26/028	UCF/205/25 4 Bolt Flanged
6	26/031	FBM20/20 25id 32od x 20 Flanged
7	26/042	Seloc Pin M3 x 25
8	26/067	Plunger Comp Spring S/S
9	26/263	Conical Bump Stop - 512251-50
10	29/047A	PX147 Rear Panel 585 x 1345
11	29/077A	PX177 Front Panel (PRINTED)
12	30-276	Plunger
13	30-281	Pulley Spindle x 76
14	30-326	Pulley Spacers for 100mm RHS
15	30-329	Counterweight x 53.5 (CHROMED)
16	30-407	12 Dia x 75 Long Tube Spacer
17	30-415	Packer 10mm D x 10mm Chem Blk
18	30-417	Tension Bar x 100mm *SC
19	30-458	20 Dia EN16T Insert
20	30-480	Tension Pad Chem Blacked
21	30-586	Belt Clamp Bar 22x x 55mm long
22	30-677	Belt Clamp (CHROMED)
23	30-872	Index Plate for 600 (CHROMED)
24	30-985	Pulley Spindle x 110 *S CX
25	30/007	40 x 40 x 3 Black Ribbed Endcaps
26	30/009	50 x 25 x 1.25/3 Black Ribbed Insr
27	30/019	T1462M12 x 25mm High Tensile
28	30/022	Black Plastic Knob with M10 thrd.
29	30/027	Plastic Insert 40 x 40 x 2.5
30	30/035	Blanking Grommet 1/2in Dia
31	30/037	Ser No Labels .002in unlined
32	30/038	Circles 33od 22id (Sheets 10 each)
33	30/041	Arrows 7mm x 40mm 10 per sheet
34	30/048	22.23mm ID x 154mm Length Grip
35	30/065	Black Outer Inserts 40 x 40 x 2
36	30/066	White Inner Inserts 40 x 40 x 2
37	30/067	Round Inserts OD 25mm p/n
38	30/070	Magnetic Strip AB/R20
39	30/080	120mm Pulse Nameplate (CHROMED)
40	33/025	Regulator Strap 25mm wide
41	34/031	Safety Walk 4in Wide in Reels
42	35/014	M8 x 50 Hex Head HT Bolt
43	35/020	M10 x 60 C/Sunk Cap Heads
44	35/029	M10 x 90 Hex Head HT Bolt
45	35/041	M10 x 10 Skt Head Grub Screw
46	35/043	M6 x 6 Hex Sckt Grub Screw
47	35/044	M8 x 12 Hex Sckt Grub Screw
48	35/045	M10 x 35 Hex Sckt Csk Hd Screw
49	35/049	2in od x 1in id x 1.5 Thick
50	35/050	1.5Dia x 1/4id Repair Washer
51	35/056	M8 x 16 Hex Skt Knurl Cap Screw
52	35/068C	M10 Domenuits (CHROMED)
53	35/071	M10 Nyloc Nut "T" Type
54	35/073	M10 Lock Nut Right Hand
55	35/074	M10 Washer Form "B"
56	35/075	1/2in Starlock Domeswasher
57	35/076	Plastic Washer 1.1/2in od
58	35/078	Plastic Washer 1.3/4in od
59	35/080	M8 Washer Form A Bright Zinc
60	35/092	M10 x 25 Hex Skt Button Hd Screw
61	35/093	M6 x 12 Hex Skt Button Hd Screw
62	35/102	M8 Half Nut Zinc Plated
63	35/108	M8 x 30 Hex Skt Button Hd Screw
64	35/121	M8 x 16 Hex Hd HT Set Screw
65	35/130	M8 Spring Washer Single Coil
66	35/200	Pine Tree Clips G Head
67	6-219	Belt Guard
68	6-220	Belt Guard
69	60-100	Clamp Plates (CHROMED)
70	60-106	75 x 25 x 352 Plastic 5kg Std Wt
71	60-107	75 x 25 x 352mm Plastic 5kg Top Wt
72	60-264	Guide Bar Locating Plate
73	600-100	Seat (CHROMED)
74	600-102	Short Adjuster (CHROMED)
75	600-103	Long Abdom. Adjuster (CHROMED)
76	70-101	Nylon Muffie 25mm Dia
77	70-106	Top Weight Insert
78	70-129	Tension Pad Black Nylon
79	70-301	Pulley for low Line Models
80	70-309	Limit Sticker (Red Letters)
81	35/054	M6 x 30 Hex Skt Cap Screw
82	35/067	No 6 Self tapper
83	35/083	M6 Washer Form A
84	35/097	M10 x 35 Hex Skt Button Hd
85	600-E3	Arm Assembly
86	600-E5	Operating Arm Assembly
87	600-E6	Cam Assembly
88	600-E7	Seat Frame Assembly
89	600-E10	Support Arm Assembly
90	600-E11	Limiter Plate Assembly
91	600-E12	Footplate Assembly
92	U600/0001	Back Pad
93	U600/0002	Back Pad Wear Cover
94	U600/0003	Seat Pad
95	U600/0004	Chest Pad
96	U600/0005	Chest Pad Wear Cover
97	35/113	M10 Cover
98	35/122	M8 Cover
99		Multi Pin 30-835

600E Abdominal